

## SFCI

### Female Connector

Standard



i-Fitting

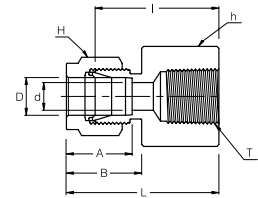

### Connects Fractional Tubes To Male NPT Thread

Part No.	Tube OD D (inch)	T (NPT)	d Min	Width Across Flat		A	B	I	L
				h (inch)	H (inch)				
SFCI - 4 - 2N	1/4	1/8	4.82	9/16	9/16	15.24	17.78	23.87	31.24
SFCI - 4 - 4N	1/4	1/4	4.82	3/4	9/16	15.24	17.78	28.44	35.81
SFCI - 4 - 6N	1/4	3/8	4.82	7/8	9/16	15.24	17.78	30.22	37.59
SFCI - 4 - 8N	1/4	1/2	4.82	1-1/16	9/16	15.24	17.78	35.05	42.41
SFCI - 6 - 2N	3/8	1/8	7.11	5/8	11/16	16.76	19.30	25.40	32.76
SFCI - 6 - 4N	3/8	1/4	7.11	3/4	11/16	16.76	19.30	30.22	37.59
SFCI - 6 - 6N	3/8	3/8	7.11	7/8	11/16	16.76	19.30	31.75	39.11
SFCI - 6 - 8N	3/8	1/2	7.11	1-1/16	11/16	16.76	19.30	36.57	43.94
SFCI - 6 - 12N	3/8	3/4	7.11	1-5/16	11/16	16.76	19.30	40.38	47.75
SFCI - 8 - 4N	1/2	1/4	10.41	13/16	7/8	22.86	21.84	30.22	40.38
SFCI - 8 - 6N	1/2	3/8	10.41	7/8	7/8	22.86	21.84	31.75	41.91
SFCI - 8 - 8N	1/2	1/2	10.41	1-1/16	7/8	22.86	21.84	36.57	46.73
SFCI - 8 - 12N	1/2	3/4	10.41	1-5/16	7/8	22.86	21.84	38.10	48.26
SFCI - 12 - 8N	3/4	1/2	15.74	1-1/16	1-1/8	24.38	21.84	36.57	46.73
SFCI - 12 - 12N	3/4	3/4	15.74	1-5/16	1-1/8	24.38	21.84	38.10	48.26
SFCI - 16 - 12N	1	3/4	22.35	1-3/8	1-1/2	31.24	26.41	41.14	53.34
SFCI - 16 - 16N	1	1	22.35	1-5/8	1-1/2	31.24	26.41	50.03	62.23

### Connects Metric Tubes To Male ISO Thread Thread

Part No.	Tube OD D	T (PT)	d Min	Width Across Flat		A	B	I	L
				h	H				
SFCI - 6M - 2R	6	1/8	4.8	14	14	15.3	17.7	23.9	31.3
SFCI - 6M - 4R	6	1/4	4.8	19	14	15.3	17.7	28.4	35.8
SFCI - 6M - 6R	6	3/8	4.8	22	14	15.3	17.7	30.2	37.6
SFCI - 8M - 4R	8	1/4	6.4	19	16	16.2	18.6	29.5	37.0
SFCI - 8M - 6R	8	3/8	6.4	22	16	16.2	18.6	31.0	38.5
SFCI - 8M - 8R	8	1/2	6.4	27	16	16.2	18.6	35.8	43.3
SFCI - 10M - 6R	10	3/8	7.9	22	19	17.2	19.5	31.8	39.4
SFCI - 10M - 8R	10	1/2	7.9	27	19	17.2	19.5	36.6	44.2
SFCI - 12M - 8R	12	1/2	9.5	27	22	22.8	22.0	36.6	46.7
SFCI - 12M - 12R	12	3/4	9.5	35	22	22.8	22.0	38.9	49.0
SFCI - 16M - 8R	16	1/2	12.7	27	25	24.4	22.0	36.8	46.9
SFCI - 20M - 12R	20	3/4	15.9	35	32	26.0	22.0	39.6	49.7
SFCI - 25M - 12R	25	3/4	21.8	35	38	31.3	26.5	41.1	53.4
SFCI - 25M - 16R	25	1	21.8	41	38	31.3	26.5	50.0	62.3

- Dimensions and Drawings are for reference only and are subject to change without prior notice.

- Unless otherwise specified, all dimensions are in millimeters.

- Sizes, pressure classes, and end connections not listed are available upon request.

- Dimensions shown with SUPERLOK nuts finger-tight, where applicable.